

Soils Map

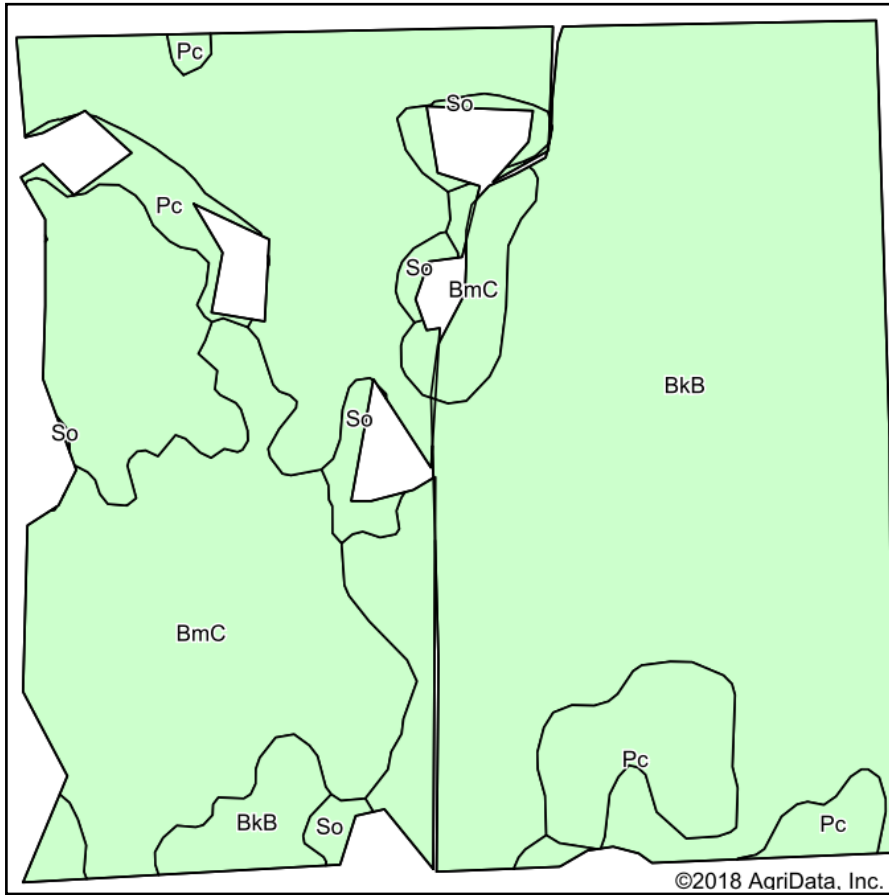

Soils data provided by USDA and NRCS.

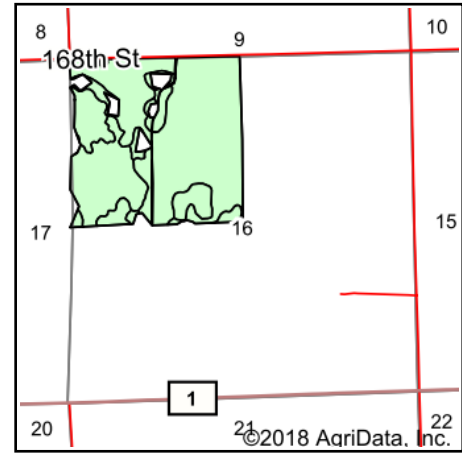

State: **South Dakota**
 County: **Deuel**
 Location: **16-117N-49W**
 Township: **Portland**
 Acres: **149.22**
 Date: **9/12/2018**

United Country
ADVANTAGE Land CO.

Maps Provided By:



Area Symbol: SD039, Soil Area Version: 20

Code	Soil Description	Acres	Percent of field	Non-Irr Class *c	Productivity Index	Corn	Soybeans	Winter wheat	NCCPI Soybeans
BkB	Barnes-Svea loams, 1 to 6 percent slopes	106.28	71.2%	Ile	83	84	31	40	51
BmC	Barnes-Svea-Buse loams, 2 to 9 percent slopes	29.78	20.0%	IIle	64	69	25	34	51
Pc	Parnell-Vallers complex	9.65	6.5%	Vw	40	38	13	4	15
So	Southam silty clay loam, 0 to 1 percent slopes	3.51	2.4%	VIIIw	10				2
Weighted Average					74.7	76.1	27.9	35.5	47.5

*c: Using Capabilities Class Dominant Condition Aggregation Method

Soils data provided by USDA and NRCS.