

# Soils Map

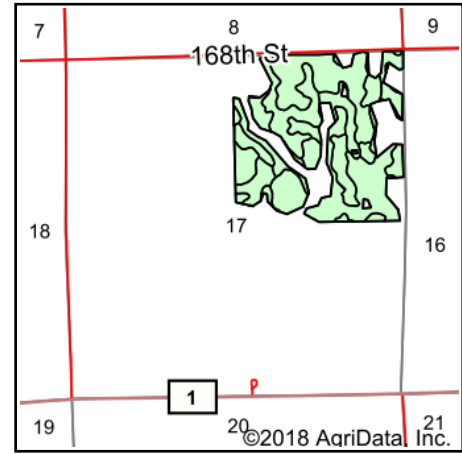
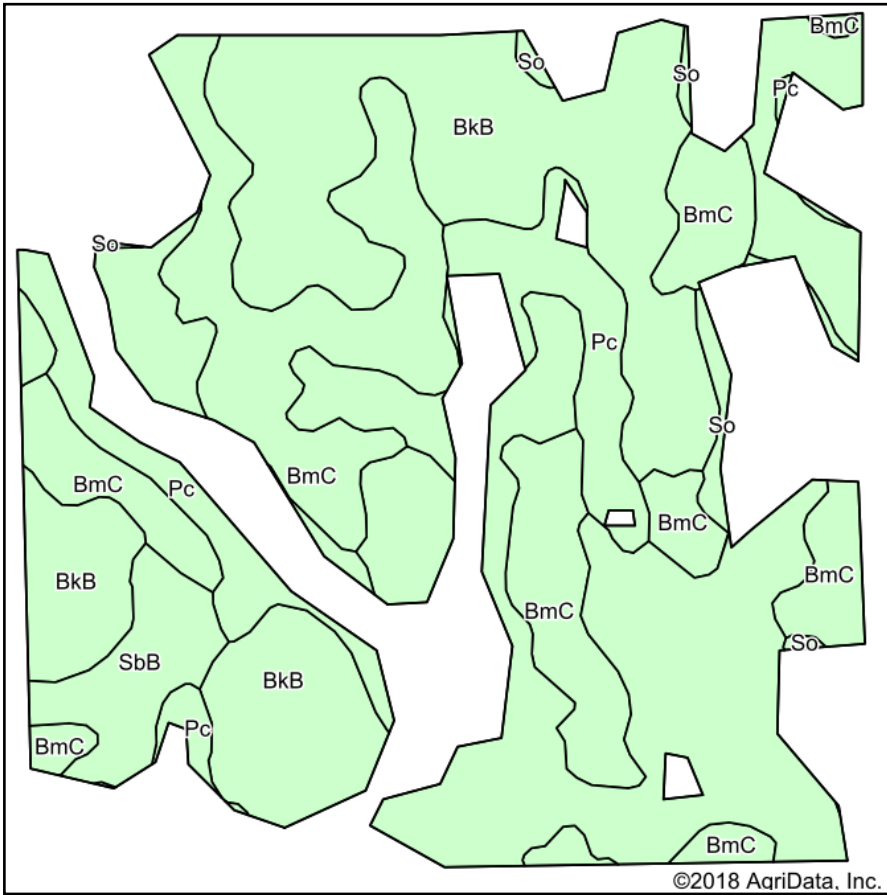

State: **South Dakota**  
 County: **Deuel**  
 Location: **17-117N-49W**  
 Township: **Portland**  
 Acres: **114.37**  
 Date: **9/12/2018**

**United Country**  
**ADVANTAGE Land CO.**

Maps Provided By:  
  
 CUSTOMIZED ONLINE MAPPING  
 © AgriData, Inc. 2018 www.AgriDataInc.com



Soils data provided by USDA and NRCS.

## Area Symbol: SD039, Soil Area Version: 20

Code	Soil Description	Acres	Percent of field	Non-Irr Class *c	Productivity Index	Corn	Soybeans	Winter wheat	NCCPI Soybeans
BkB	Barnes-Svea loams, 1 to 6 percent slopes	62.25	54.4%	Ile	83	84	31	40	51
BmC	Barnes-Svea-Buse loams, 2 to 9 percent slopes	29.77	26.0%	IIIe	64	69	25	34	51
Pc	Parnell-Vallers complex	15.65	13.7%	Vw	40	38	13	4	15
SbB	Sinai silty clay, 2 to 6 percent slopes	5.18	4.5%	IIIe	71	75	28	36	43
So	Southam silty clay loam, 0 to 1 percent slopes	1.52	1.3%	VIIIw	10				2
<b>Weighted Average</b>					<b>70.7</b>	<b>72.3</b>	<b>26.4</b>	<b>32.8</b>	<b>45.1</b>

\*c: Using Capabilities Class Dominant Condition Aggregation Method

Soils data provided by USDA and NRCS.