

### Building Sketch (Page - 1)

Borrower				
Property Address 2622 N Hwy 144				
City	Glen Rose	County	Somervell	State TX Zip Code 76043
Lender/Client				

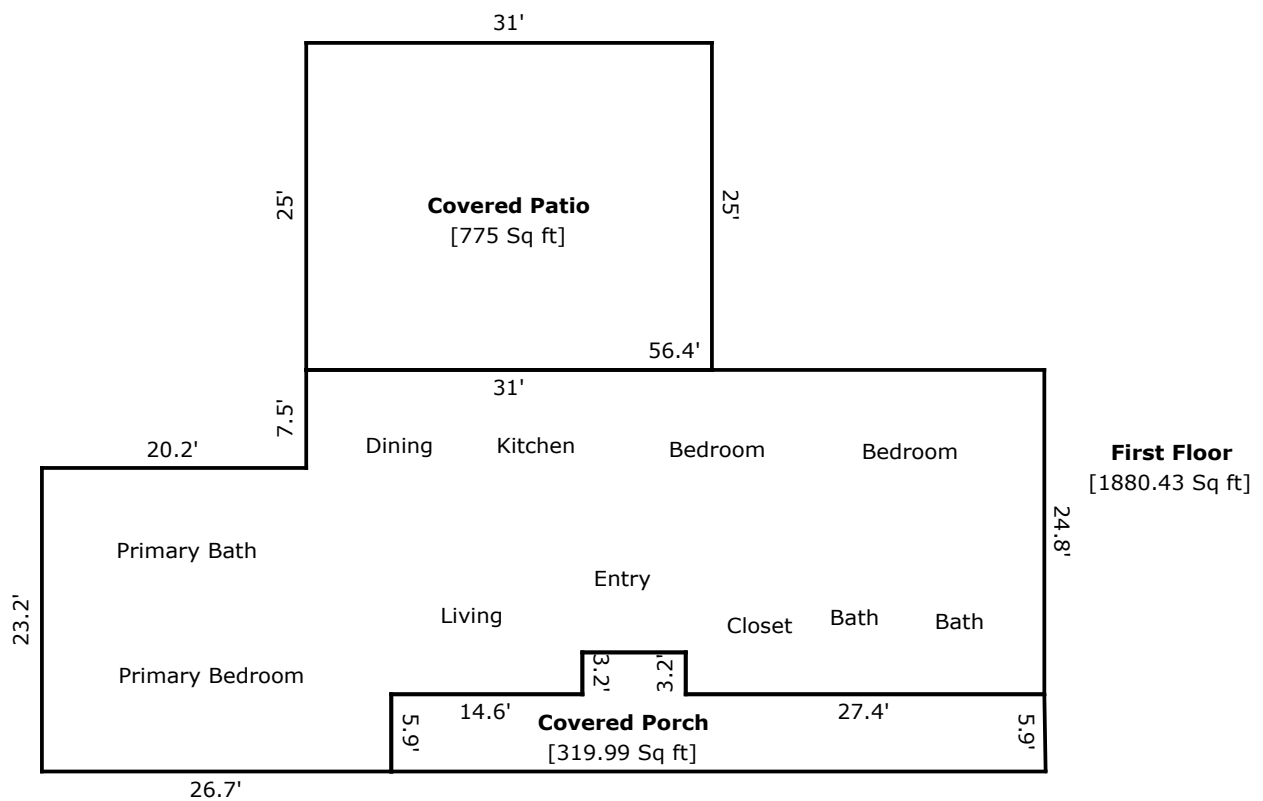

**First Floor**  
[1880.43 Sq ft]

TOTAL Sketch by a la mode, inc.

#### Area Calculations Summary

Living Area		Calculation Details	
First Floor	1880.43 Sq ft	24.8 × 27.4	= 679.52
		23.2 × 20.2	= 468.64
		6.5 × 5.9	= 38.35
		24.8 × 21.1	= 523.28
		7.9 × 21.6	= 170.64
<b>Total Living Area (Rounded):</b>	<b>1880 Sq ft</b>		
Non-living Area			
Covered Patio	775 Sq ft	31 × 25	= 775
Covered Porch	319.98 Sq ft	7.9 × 3.2	= 25.28
		5.9 × 49.9	= 294.41
		0.5 × 5.9 × 0.1	= 0.3

### Building Sketch (Page - 2)

Borrower				
Property Address	Hendon			
City	Glen Rose	County	Somervell	State TX Zip Code 76043
Lender/Client				

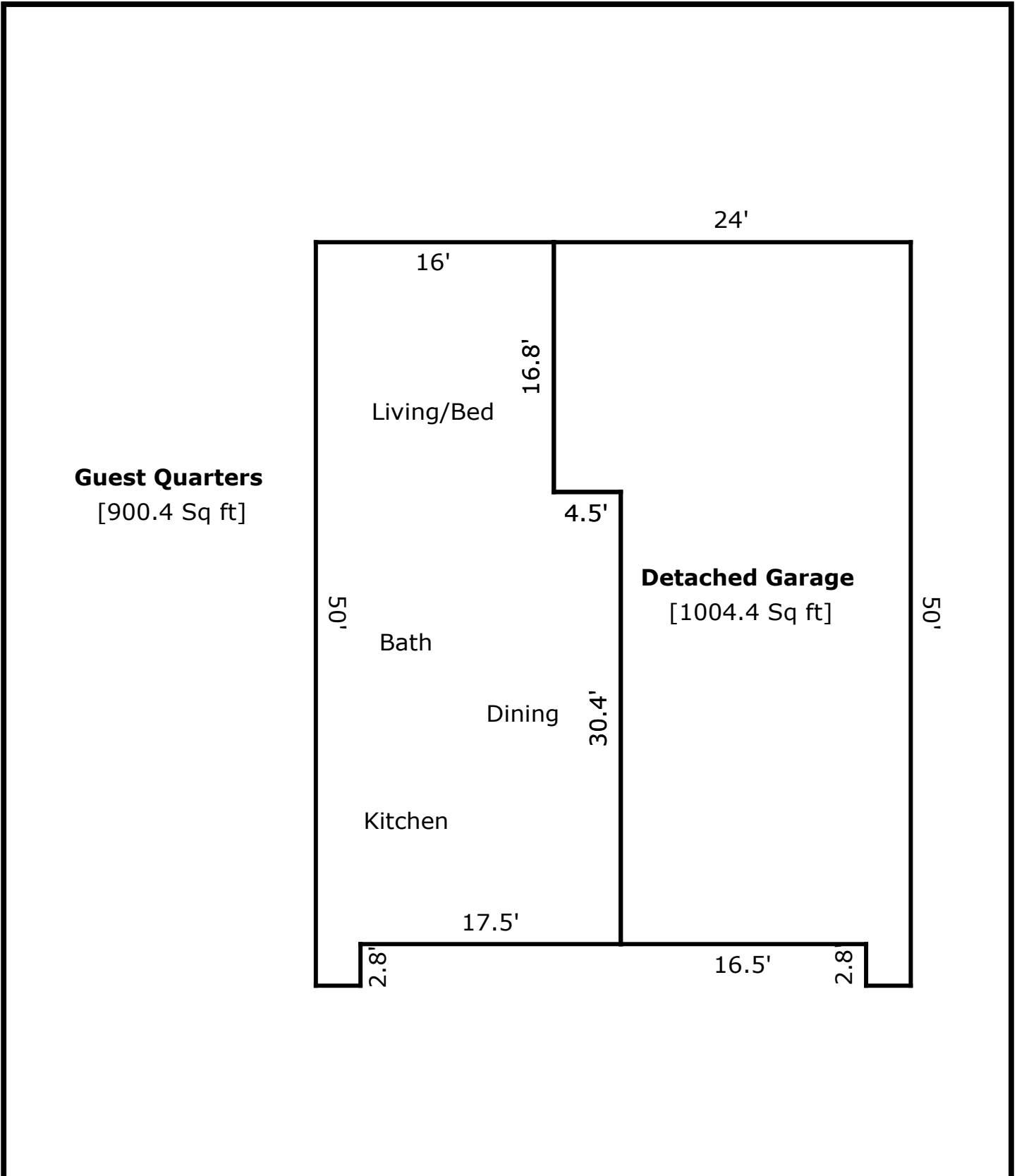

TOTAL Sketch by a la mode, inc.

**Area Calculations Summary**

Living Area		Calculation Details	
Guest Quarters	900.4 Sq ft	$16 \times 16.8 = 268.8$	$3 \times 2.8 = 8.4$
		$20.5 \times 30.4 = 623.2$	
<b>Total Living Area (Rounded):</b>	<b>900 Sq ft</b>		
Non-living Area		Calculation Details	
Detached Garage	1004.4 Sq ft	$3 \times 2.8 = 8.4$	$24 \times 16.8 = 403.2$
		$30.4 \times 19.5 = 592.8$	